

CAPSTONE DESIGN PROJECT BOOK

Dillon Brown

Manus Movens
(The Hand that Moves)

Central Park, New York City

This is a speculative design project that examines the multicultural and polytheistic nature of the United States population and it's relationship to sacred space.

The current landscape of religious architecture, sacred spaces, and society is an isolated one, usually one story is reinforced in one temple. As stories gain mass, other concurrent stories with similar mass may gain tension, manifesting in ignorance and hatred. The outcomes of this assignment is to put forth a potential prototype for a multicultural and multi faith sacred space by threading together five distinct religions in a profane space.

America is a country that allows free religious express, Protected by the first Amendment of America's Constitution:

"Congress shall make no law respecting an establishment of religion, or prohibiting the free exercise thereof; or abridging the freedom of speech, or of the press; or the right of the people peaceably to assemble, and to petition the Government for a redress of grievances."

Additionally, observed is the concept that storied grow mass with each retelling . Over time their mass will create a type of metaphysical gravity, which pulls people in and keeps existing people in place.

But when one story meets another, their mass may for a tension. Each one competing for the same pool of believers who could retell it's story. It is my belief this tension manifests today in hatred, ignorance, radicalism and isolation.

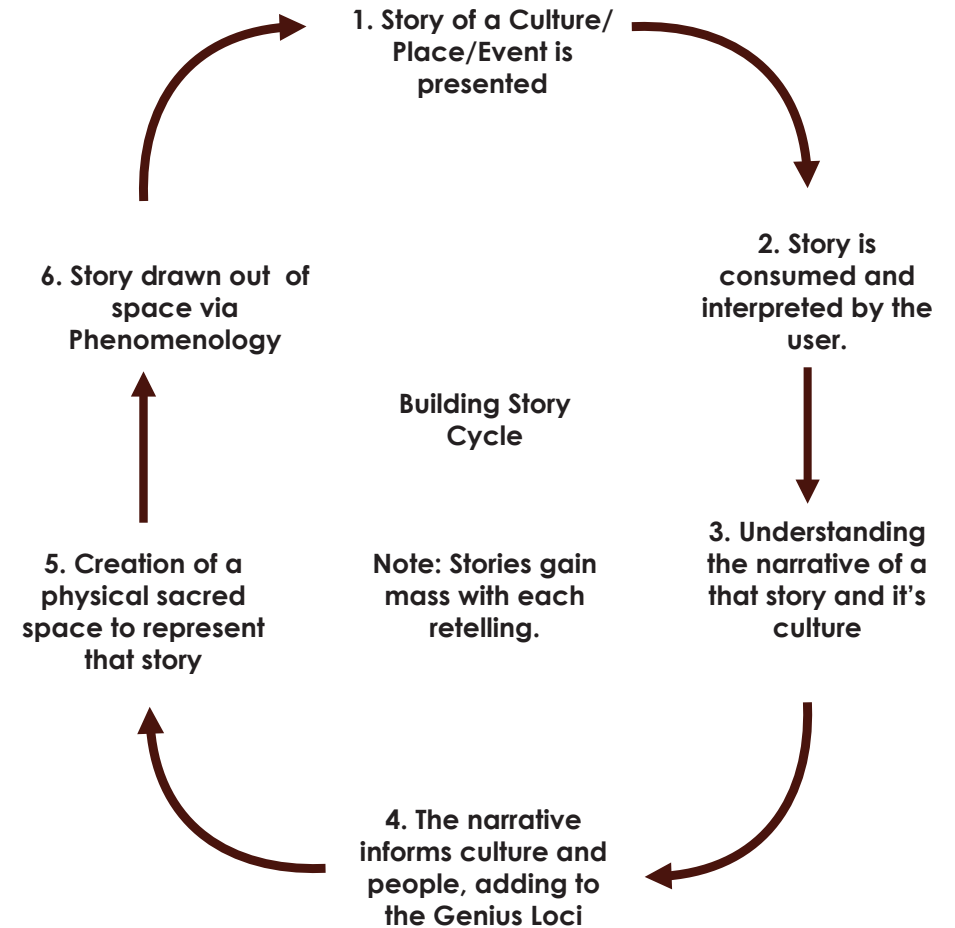

POSITION

The Existing Model is separate spaces for separate religions. While not desiring to mix religions into something new, the models that house the religions do not give the best opportunity for Americans to observe it's own multicultural nature.

Per the building story cycle, the stories that are reinforced today are singular, thus creating independent stories that work in parallel to each other. Even to the extent where there is not regular, healthy intersections that could allow for cross pollination of appreciation.

The result is religious silos at worst, and casual ignorance at best.

Furthermore, with so many independent religious structures scattered, the question of the American identity is left open. Left open for any one vocal group to try to claim it.

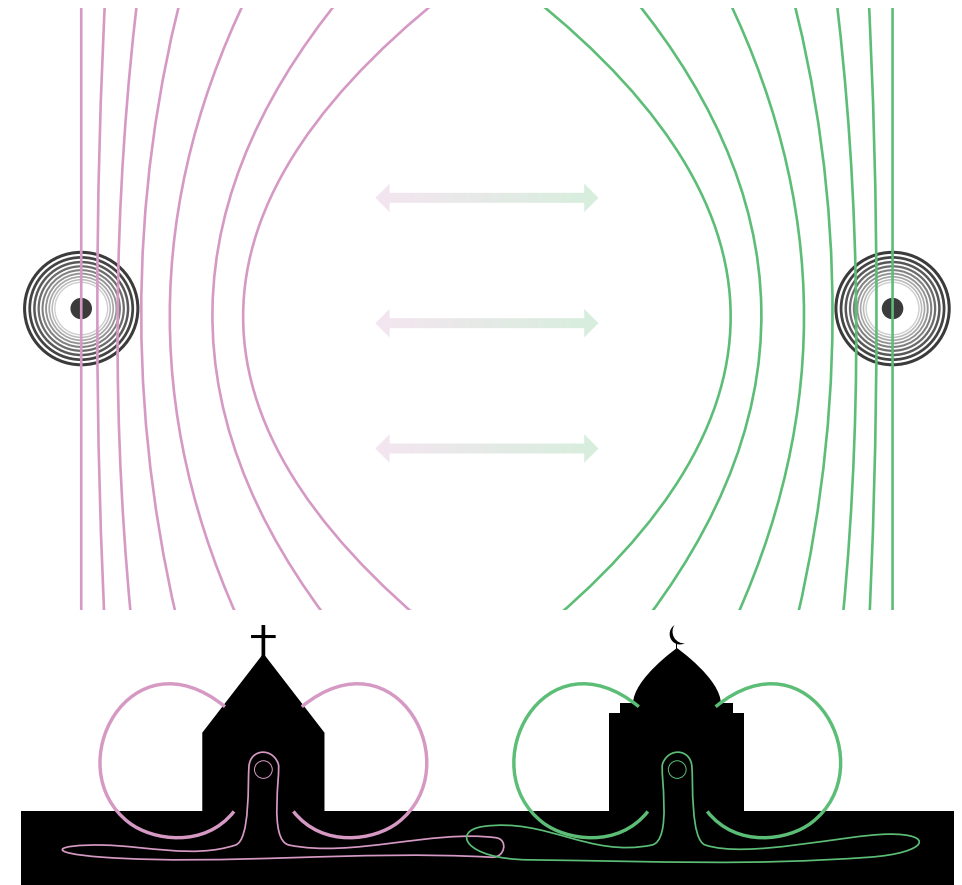

The solution, or part of the solution I offer is a Multi-faith religious center is a potential solution. It keeps each faith distinct, while validating it's existence. It then also gives opportunity to all to observe the conduct of a religion and allows people to draw their own conclusions. It is also a neutral space within a large city that is able to be helpful to visitors.

Building is a plant for: Education, Exposure, Worship, Validation, and Story telling.

The building acts as one of the many nodes in Central Park NYC, leading people in due to it's prominent locations. Once inside the building there is a raised walkway that offers a neutral manner to see the temple, style of worship, and gain a higher understanding of other cultures.

The five religious groups are loosely tied with a neutral, profane space that encourages interaction between groups. A mediator in the place of meditation.

The Religions are stationary, the people physically move, and the ideas metaphorically move.

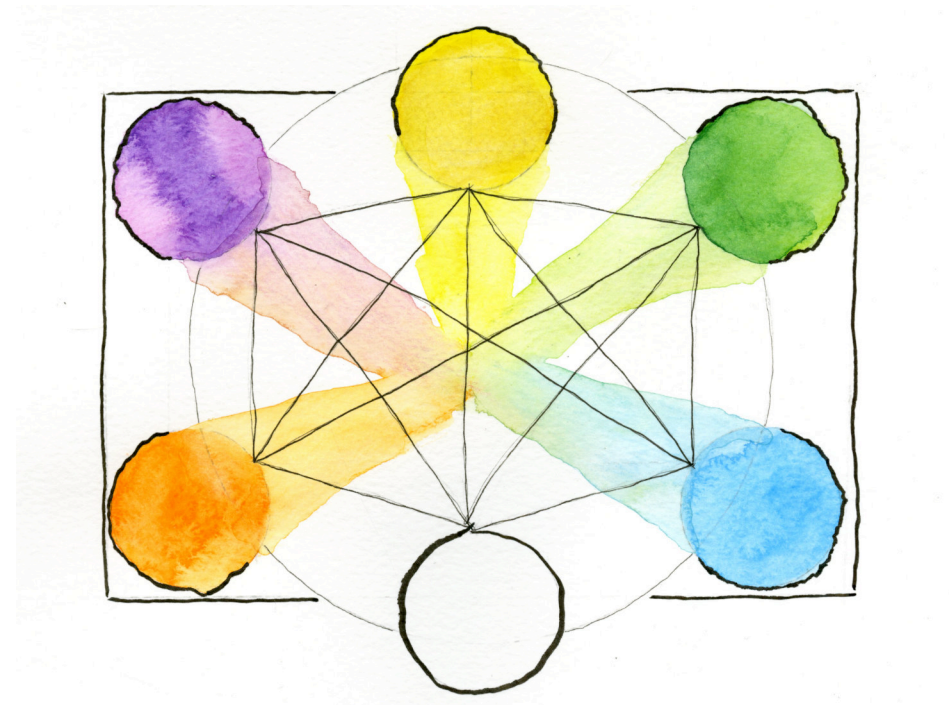

Christianity



Hinduism



Islam

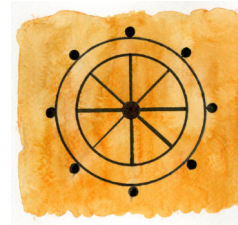

Buddhism



Judaism

Profane

SITE

Cherry Hill,
Central Park
New York, NY 10024
40.774841, -73.972633

New York City was and remains to be a historic cultural landing pad for the old world to enter the new world, with all of the opportunity it offered. Today, many people's first American city remains to be New York, due to it's access to international travel.

Subsequently, Central park is the moment of relief in a concrete jungle. The Park was previously a large forest before it was a city, and then it was a series of housing, up to and including Seneca Village.

Over time the space was purchased slowly and converted into a forested public park area filled with points of interest. These points range from public entertainment venues, shrines, fountains, playgrounds and sports arenas.

Just south of The Lake, a man made lake is a hill named Cherry Hill, This location is world famous for it's Blooming Cherry Trees cover the space in white pedals.

This location, which has direct views of The Lake, the Bethesda fountain, The ever-evolving trees, direct access to vehicular traffic, all while being in a moment of relief in a prominent city make this site desirable to carry out this design.



The building occupies the site on a small projection facing the water. On the sloped site, the higher level meets the temple level, whereas the basement level meets with the water.

The entire building is rotated 18.5 degrees, as to allow the Mosque face Mecca, and the Synagogue face Jerusalem. This rotation also forces the Buddhist temple to be in closer proximity to the Blossoming Cherry trees to the West.

In response also, the Church then was rotated to face true east, which is a characteristic found in traditional churches and cathedrals. There are three stained windows that do an additional rotation that turn and face Bethesda Fountain, a callback to the fountains of life found in the Bible.

The proximity of the building to New York City is to have the building pushed into and centralized in the park space to minimize noise, a gesture towards meditation.

Finally, the building is perceivable from many of the park nodes, and is close to the walkways. As Central Park sees over 5,000 visitors in a day during tourist season, and is a popular location throughout the winter, the temple would be connected to the community at all times.

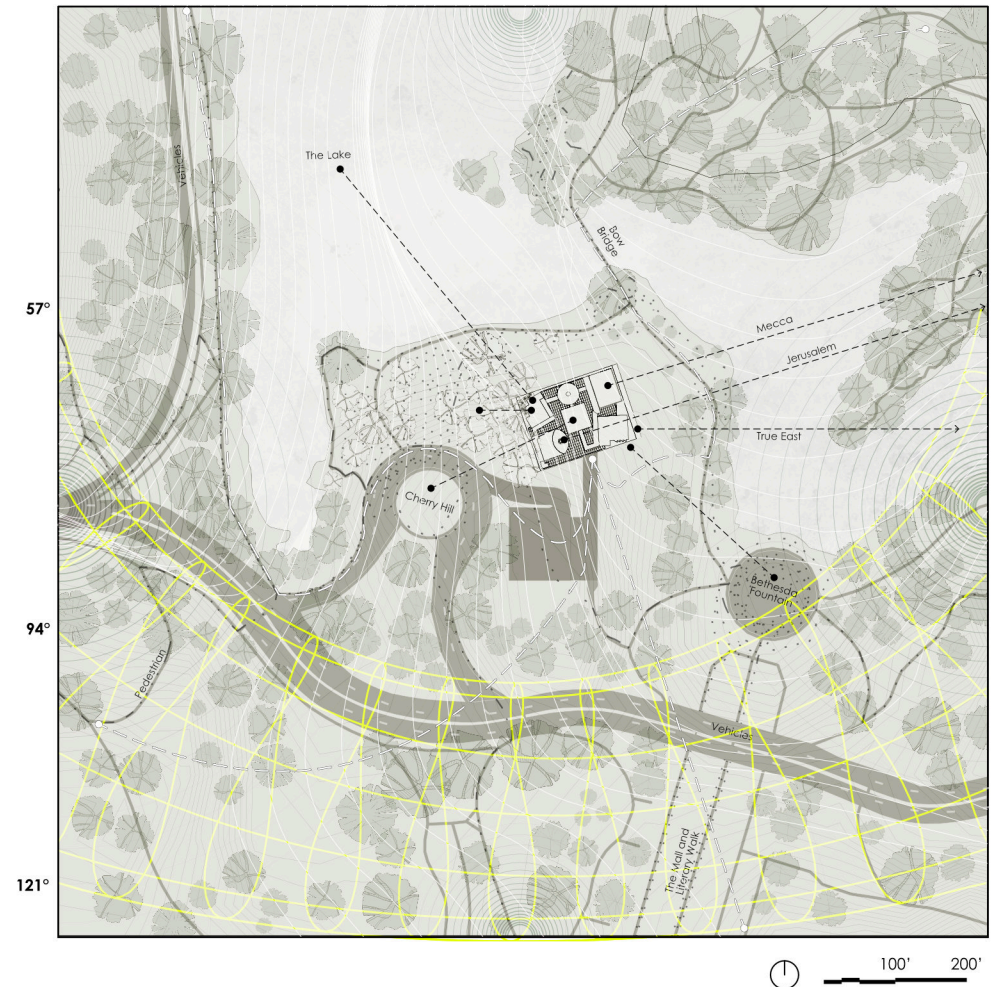

PROGRAM

As stated previously, this is a worship space infused with education and has some museum-like qualities.

Primarily the Worship space is on the ground floor, with all of the utilities and support spaces in the basement level.

This puts emphasis on the temples and the negative space between them as a mingling space.

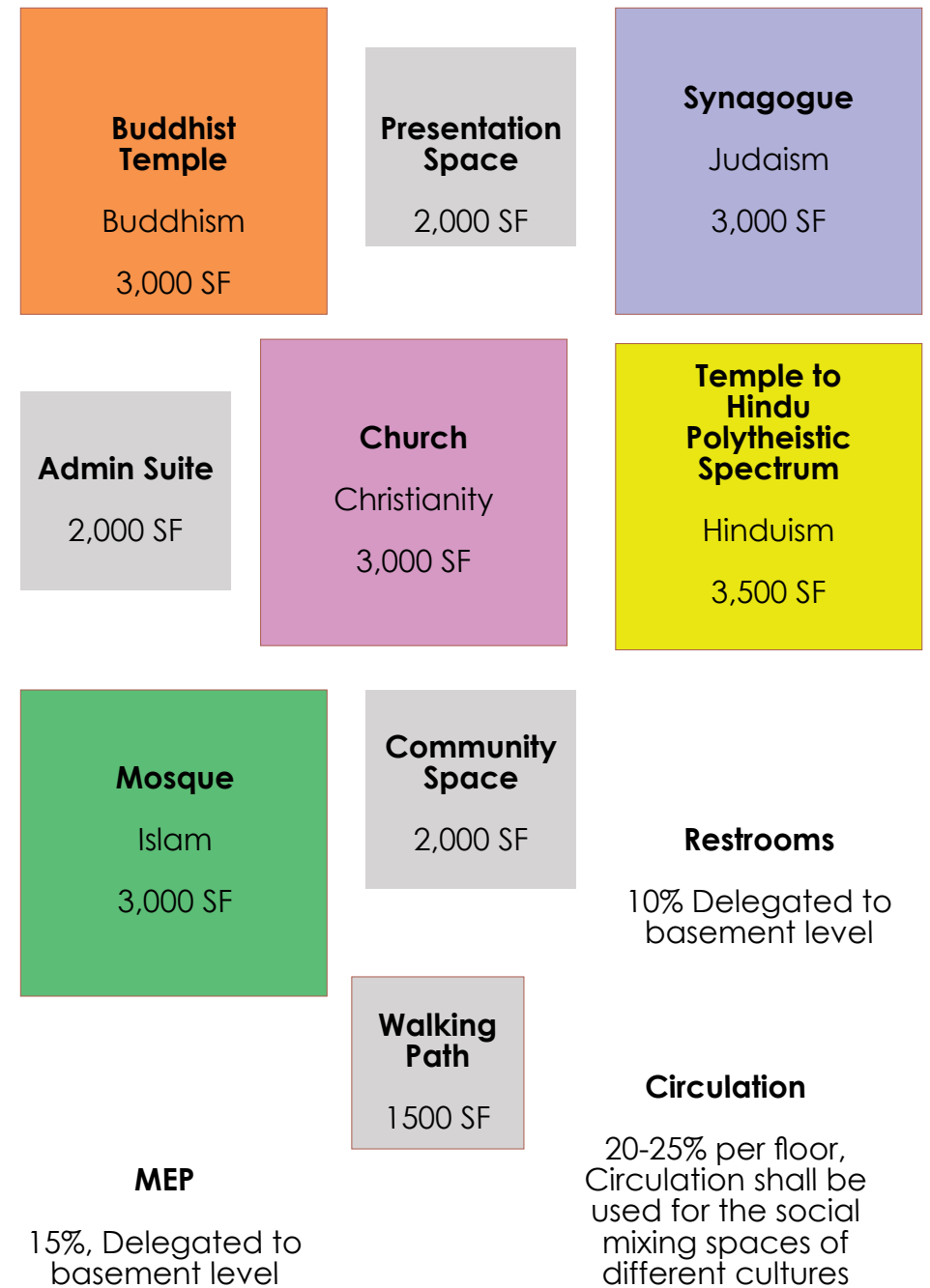

BUILDING

There are five religious temples located in this structure. As they are, they are space spaces for those who want to worship what they worship, but they are in conversation with each other.

Between the temples is a profane space of connection. The negative space is the house of communication, the piece that is not seen in other contemporary temples.

Above the temples is a connecting walkway, that grants access to view the sacred space and witness worship without participating. A secular mechanism for philosophical growth.

Below the temples is a plinth, solid, strong and heavy. It houses the mechanisms needed for a public structure of this quality.

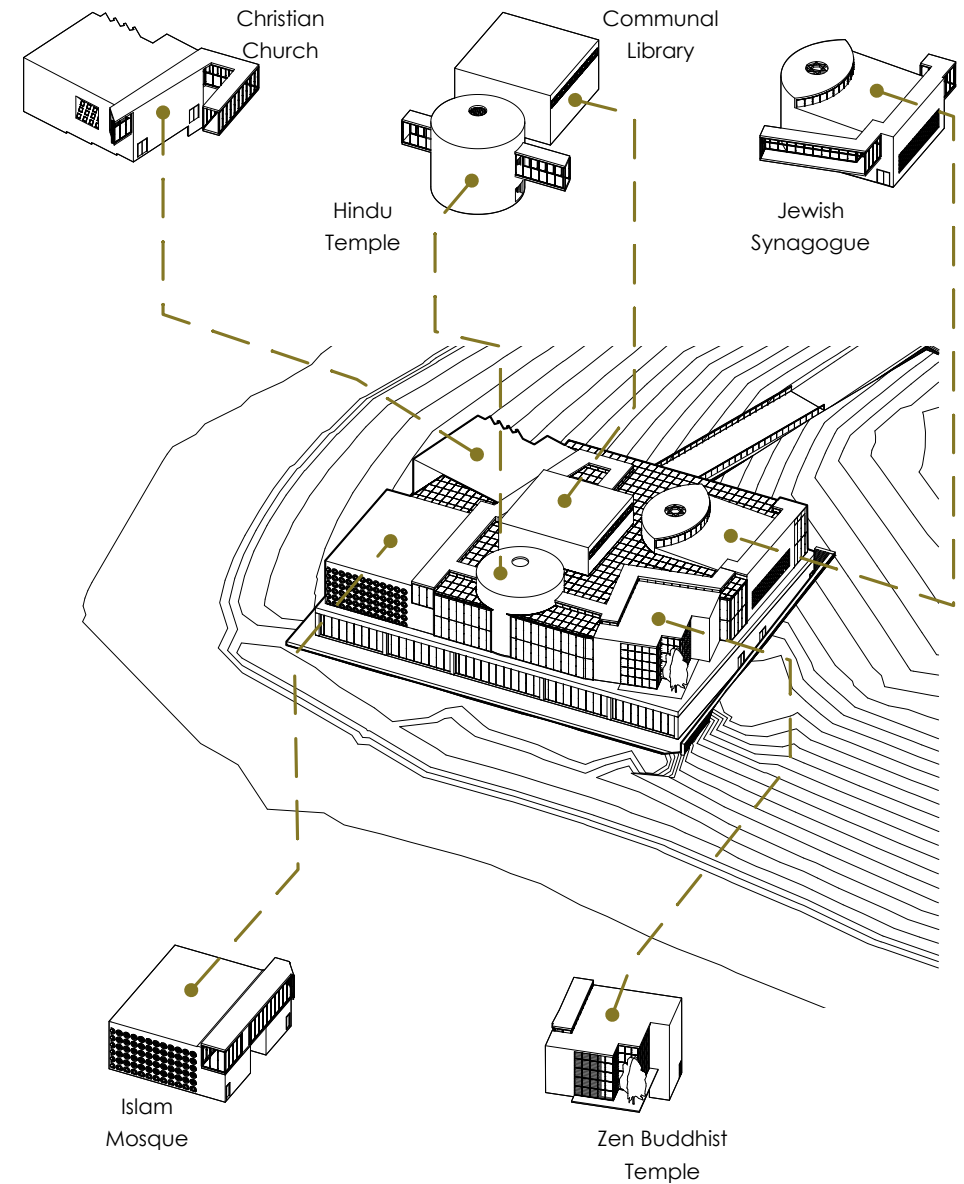
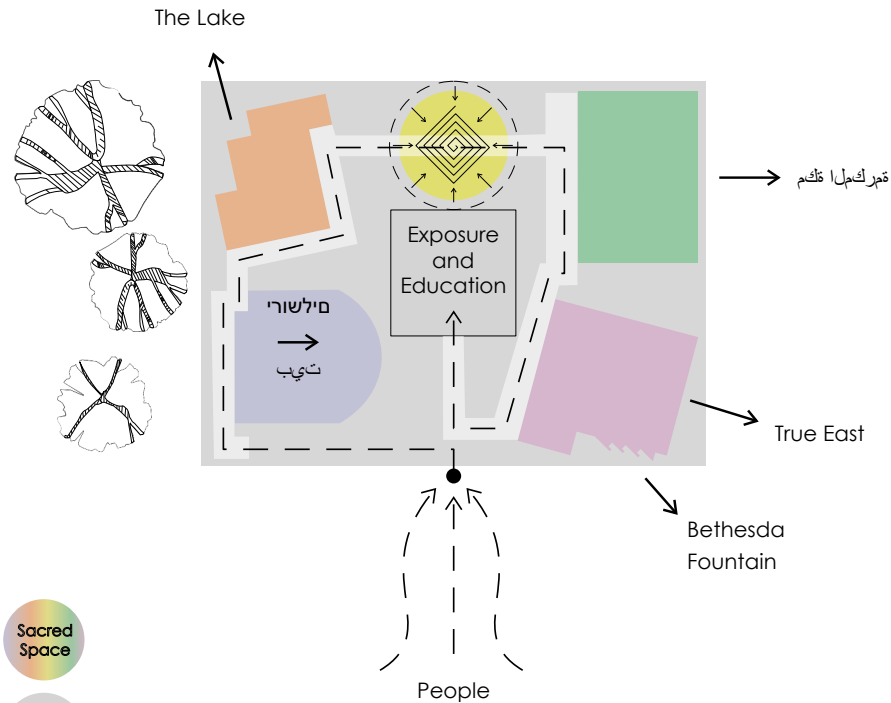

LIVING and PERFORMANCE

As with many things, the only real solution is education and exposure. This building serves as a gesture to the idea that America stands for all faiths, and while we cannot and should not force religion on anyone, exposure to your neighbors differing beliefs will lead to a less ignorant society. This exposure would also lead to a greater level of execution of the first line of the first amendment:

"Congress shall make no law respecting an establishment of religion, or prohibiting the free exercise thereof; or abridging the freedom of speech, or of the press; or the right of the people peaceably to assemble, and to petition the Government for a redress of grievances."

Within a multi-faith society, we at a legal level accept that other religions are free to exist.

However, within each temple there may be an inherent inclination to create "the echo chamber" effect wherein one's own value of their faith eclipses the respect they have for their neighbors faith.

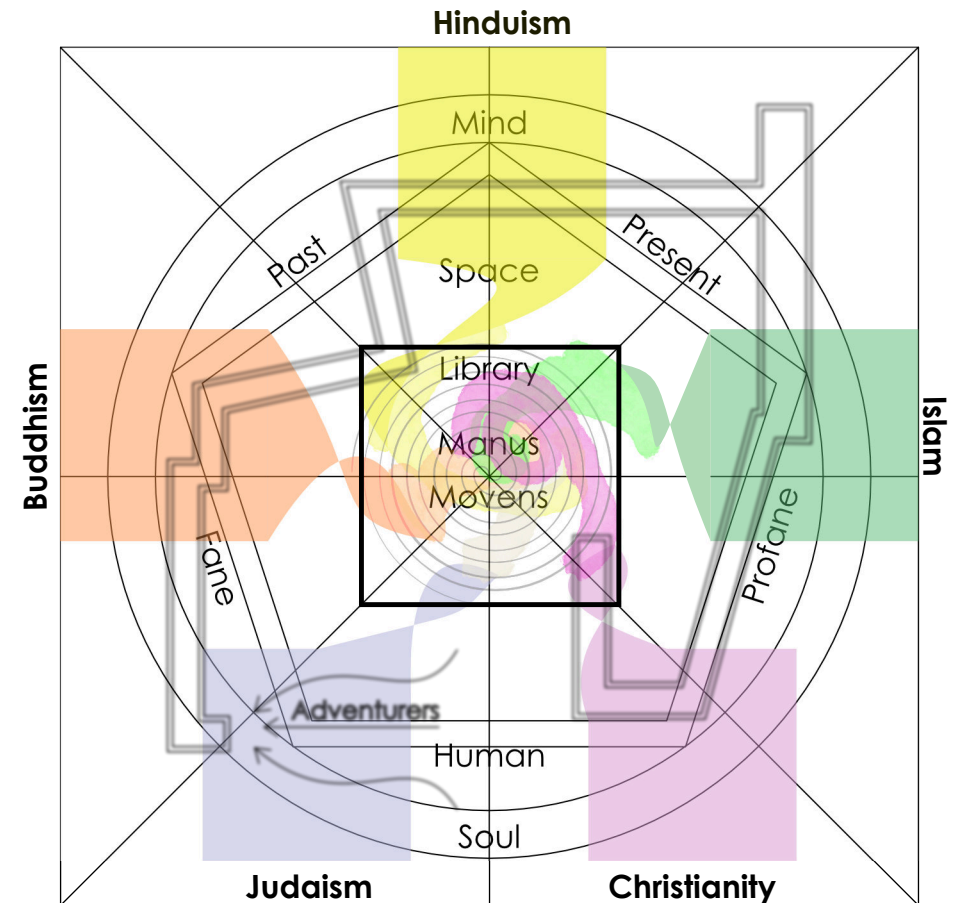
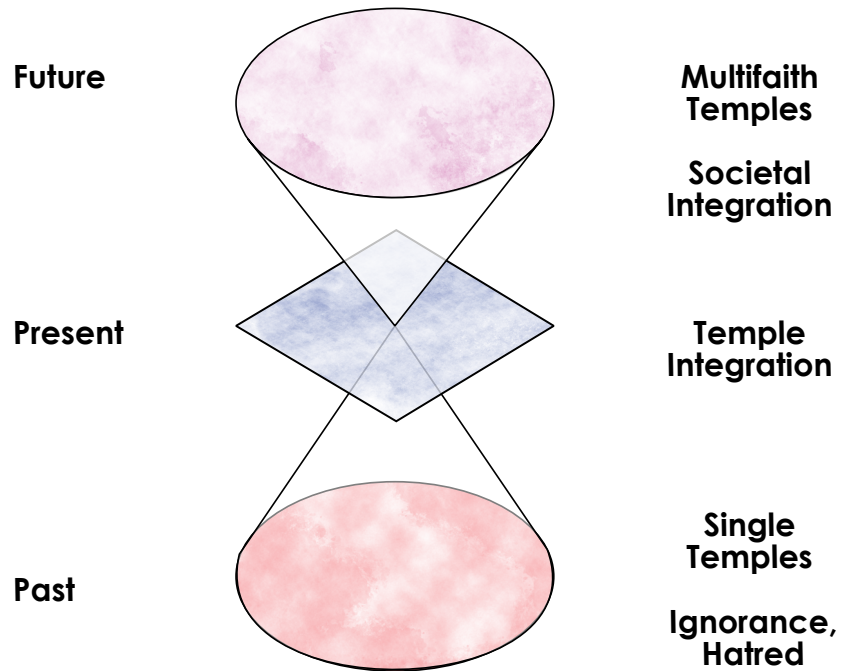

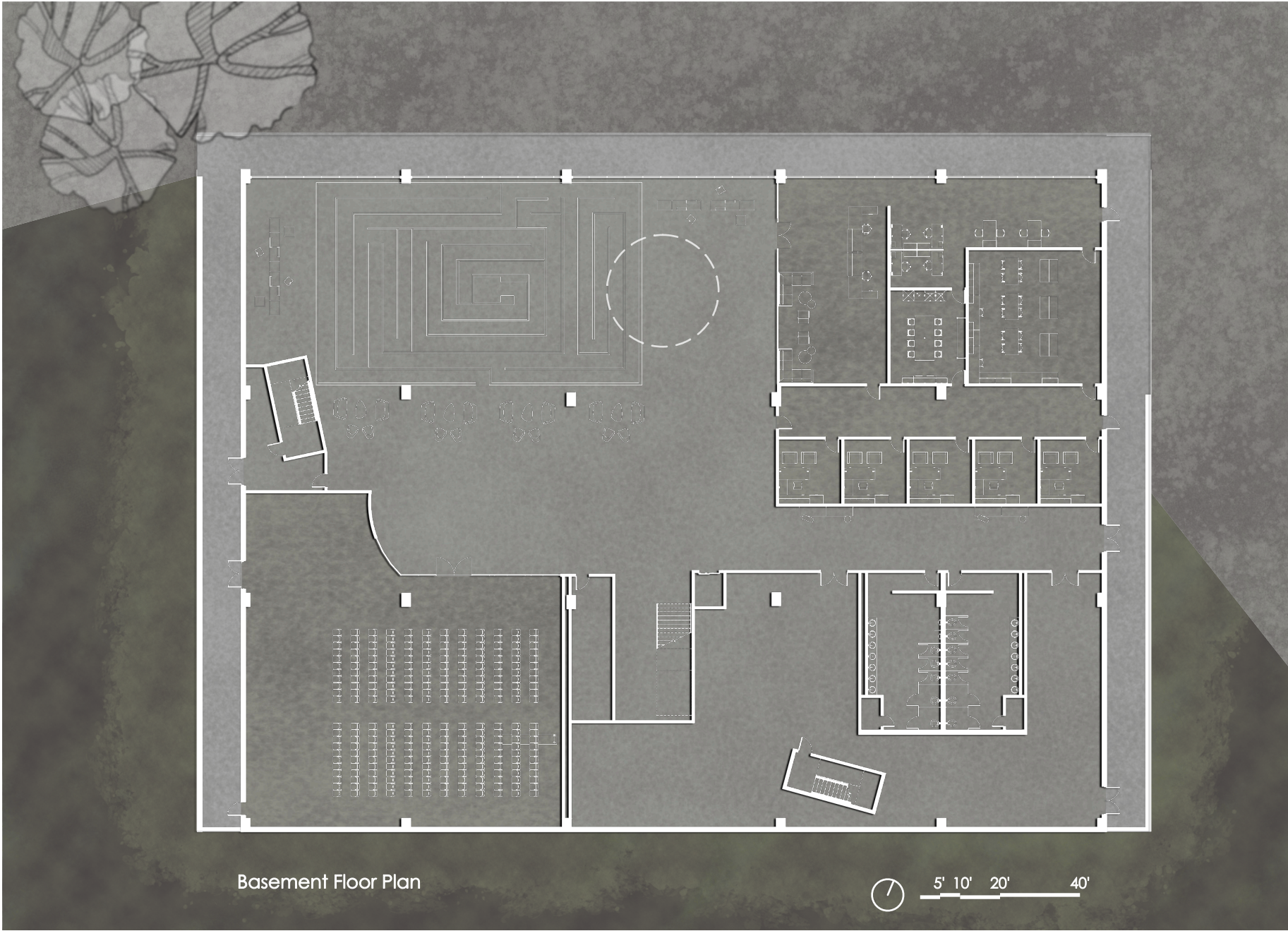

Basement Floor Plan

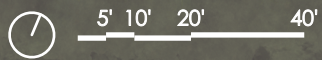

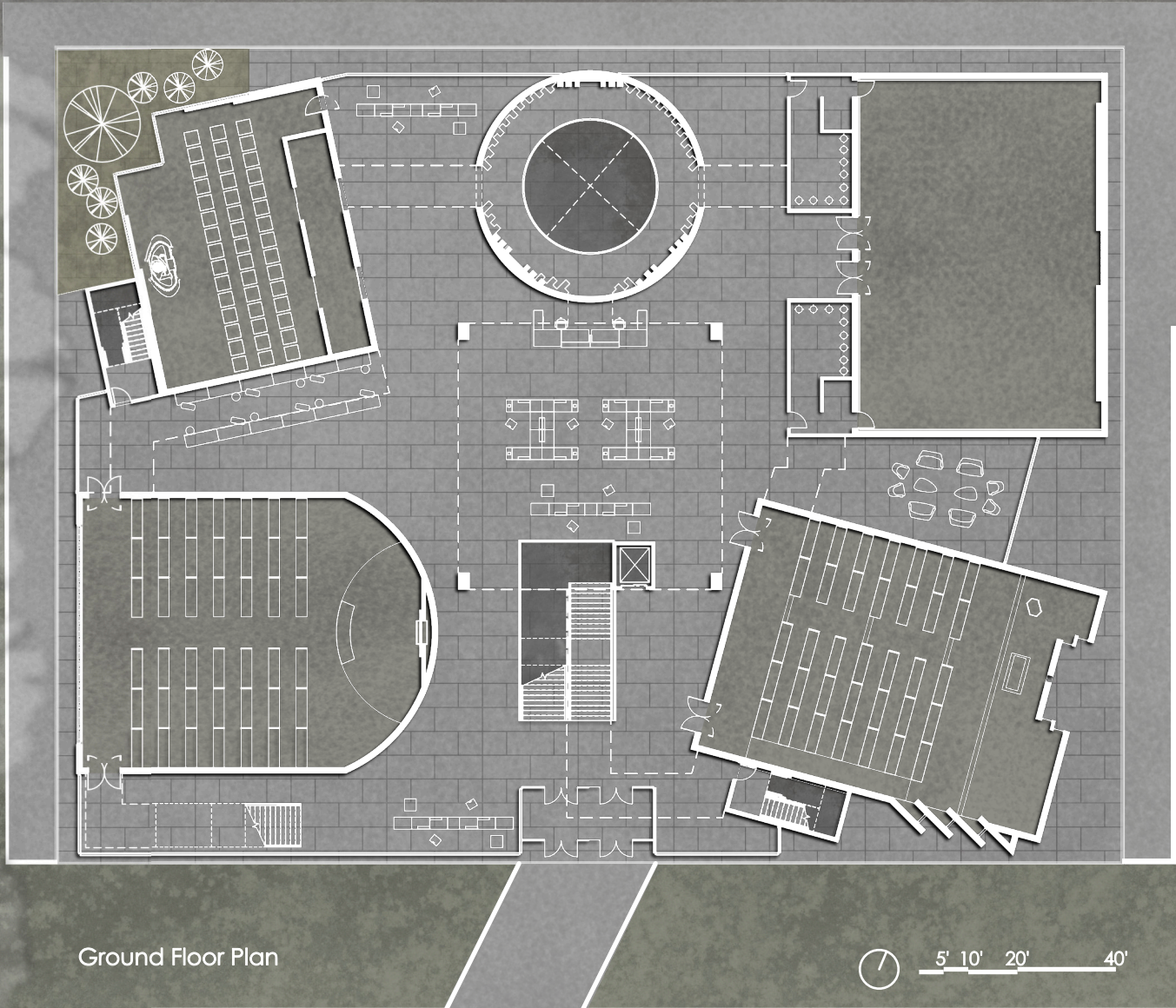

Ground Floor Plan

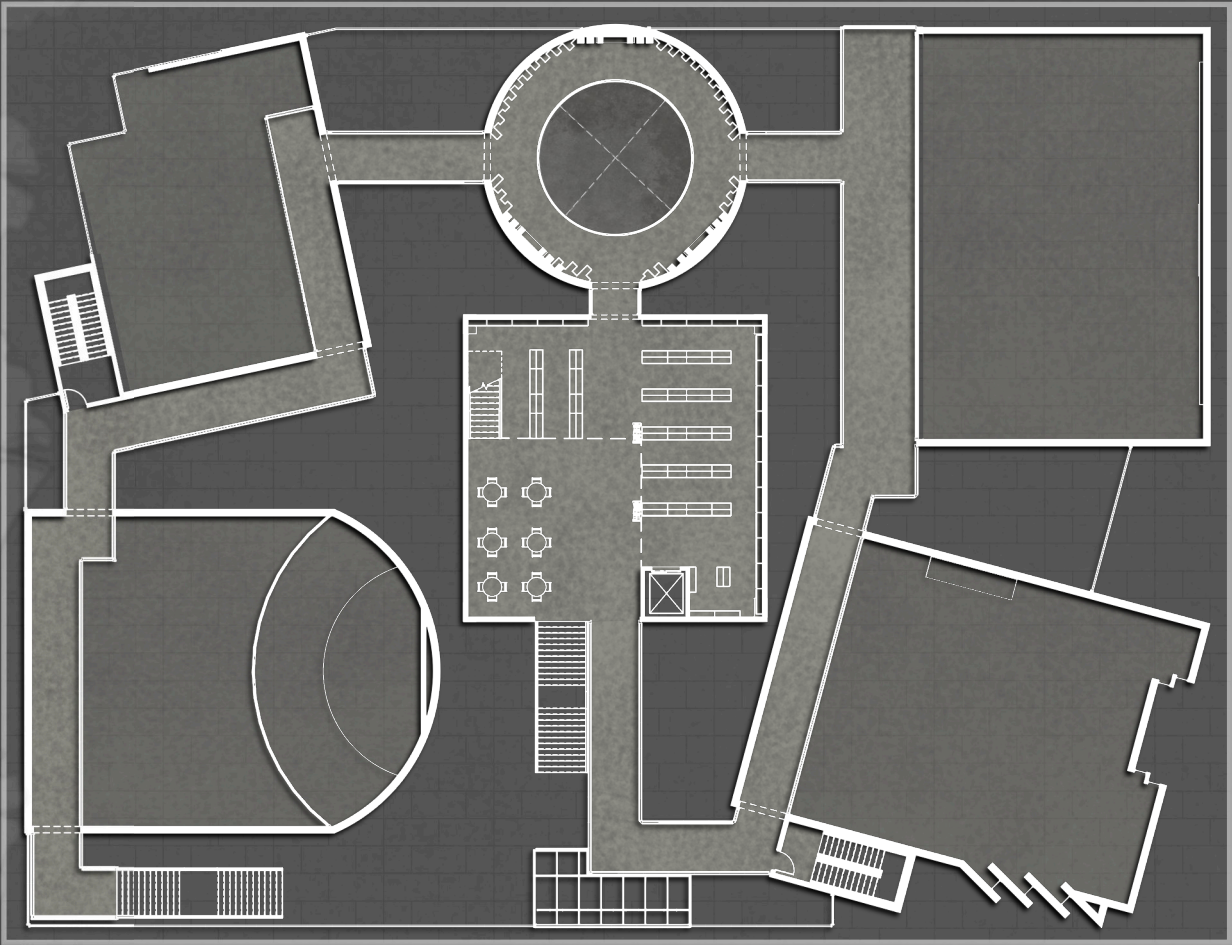

Second Floor Plan

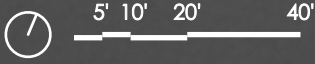

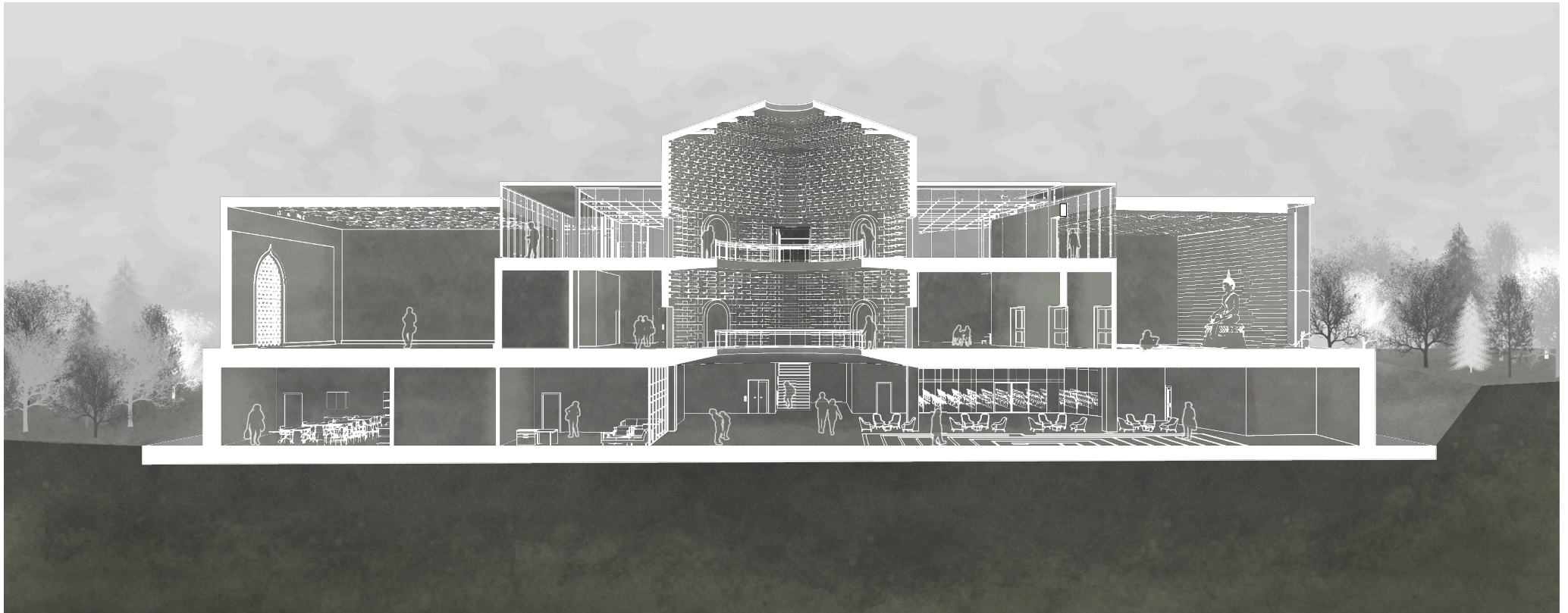

SPATIALITY

The temples are distinct on the interior but indistinct on the exterior. The mosque is full of geometry and plays on light, but it's exterior is white. This is done with the idea of figure and ground.

The figure is the community, the people who visit the temple, and ground is white with no characteristics. This makes the visitors each others focus when they are out of the temple, a gesture towards communication.

Story of Enlightenment

Second Floor

Story of Sacristy

Ground Floor

Story of Humanism

Basement

STRUCTURE

Site and Location Facts

Climate Zone: 4
 ~35' Above Sea Level
 Frost Line is Found at 36"
 Code required Wall R-Value: 19
 Code required Roof R-Value: 30
 Zone Type: **Park (Existing)**

NYC Planning Zoning Resolution

Article I Chapter 1 Resolution 11-13

Zone Type: **Special Purpose District (Proposed)**

Owner: NYC Parks and Recreation
 Managed: NYC Central Park Conservancy

Building Type: **Temple**, which is classified primarily as Assembly, or **A-3**, but will also have some **A-2, B, and E**.

Type II: Non-Combustible

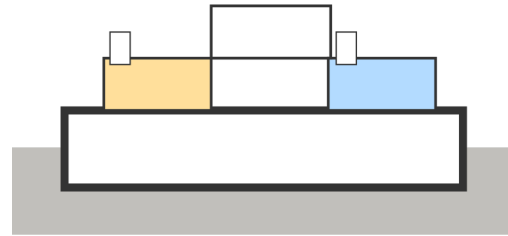

Library, light gauge steel assembly on four columns

Walking path, light gauge steel assembly

Temples, light gauge steel assembly

Plinth, heavy concrete construction

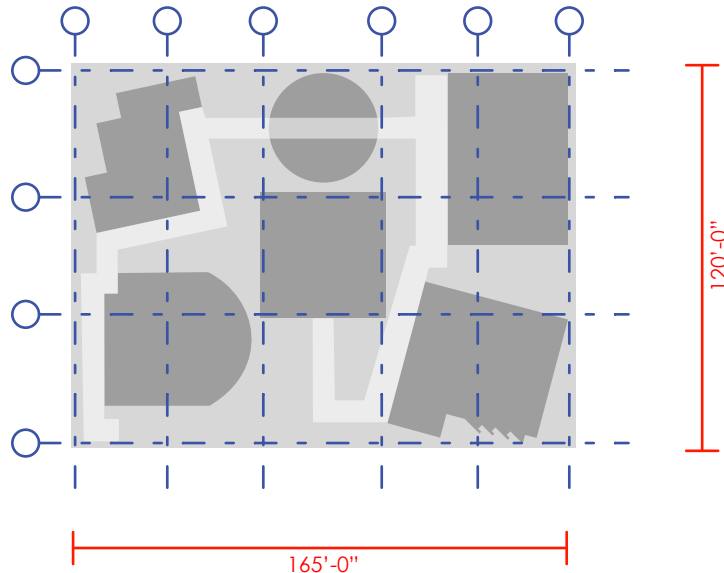

Penn State University | The Stuckeman School
 Department of Architecture

From Top to Bottom

Flat Seam Metal Roof
 Weather Resistant Barrier
 2" Rigid Foam Insulation
 Vapor Barrier
 10" Cellulose Insulation
 8" Metal Stud Framing
 5/8" Drywall Ceiling

From Exterior to Interior

White Stucco Finish
 Metal Mesh Substrate
 Scratch Coat
 Weather Resistant Barrier
 2" Rigid Foam Insulation
 Vapor Barrier
 8" Cellulose Insulation
 8" Metal Stud Framing
 5/8" Drywall Finish

From Top to Bottom

Wood T&G Floor Panel
 Raised Floor Assembly
 2" Concrete Screed
 24" Deep Precast Concrete Tee
 Lighting, HVAC, and Sprinklers
 Suspended Ceiling Assembly

From Top to Bottom

6" Polished Concrete Floor
 Vapor Barrier
 (2) 3" Rigid Foam Insulation
 Earth

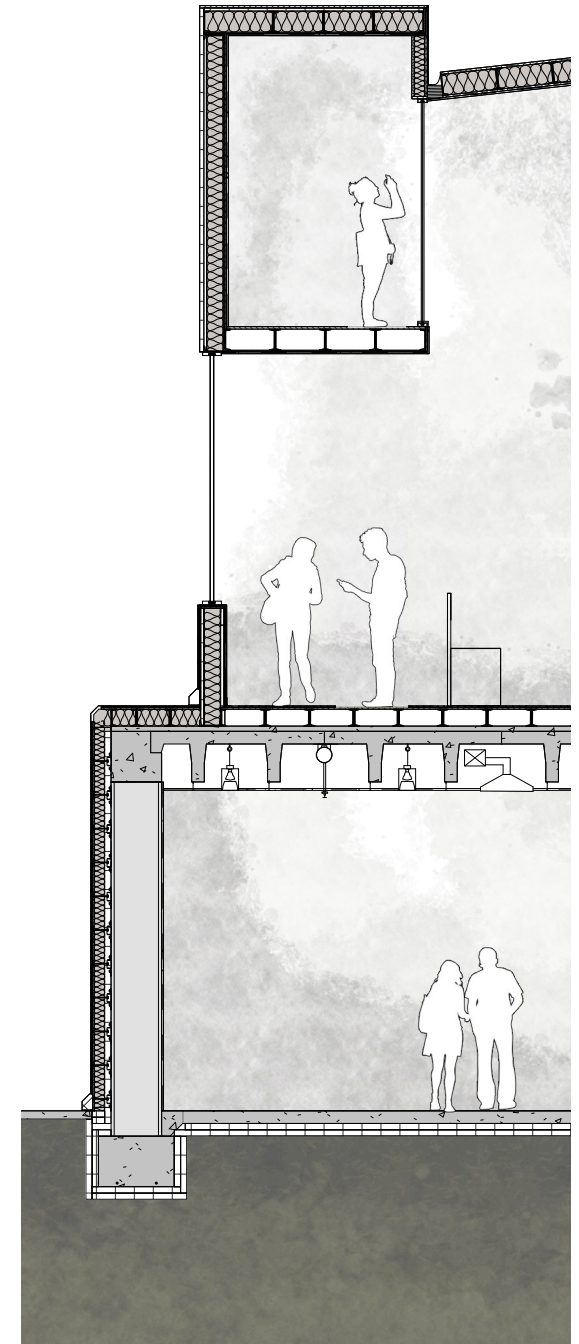

CAPSTONE DESIGN PROJECT BOOK
 Architectural Design-Inquiry | March Studio



Entrance Walkway

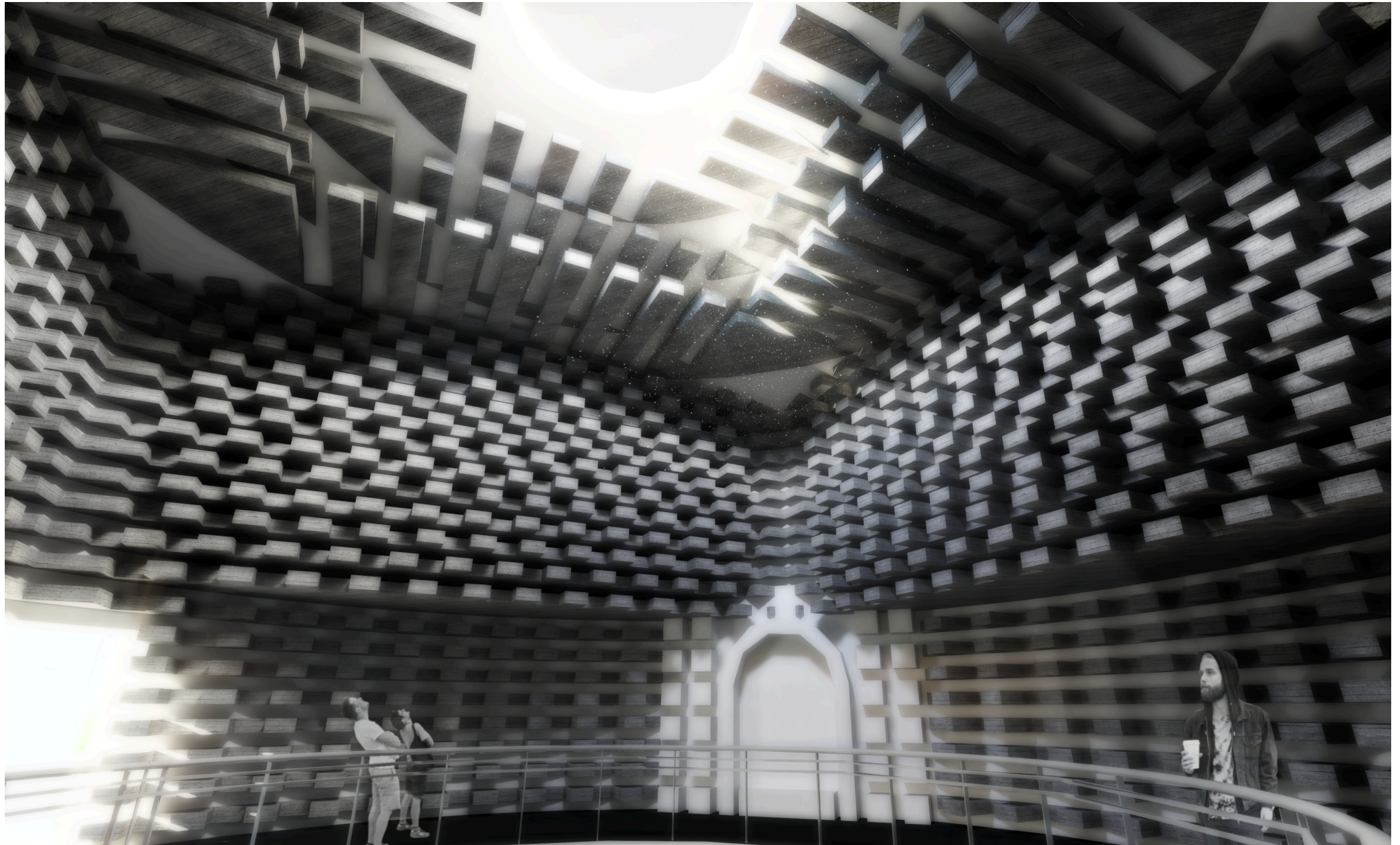

Hindu Temple



Mosque



Church

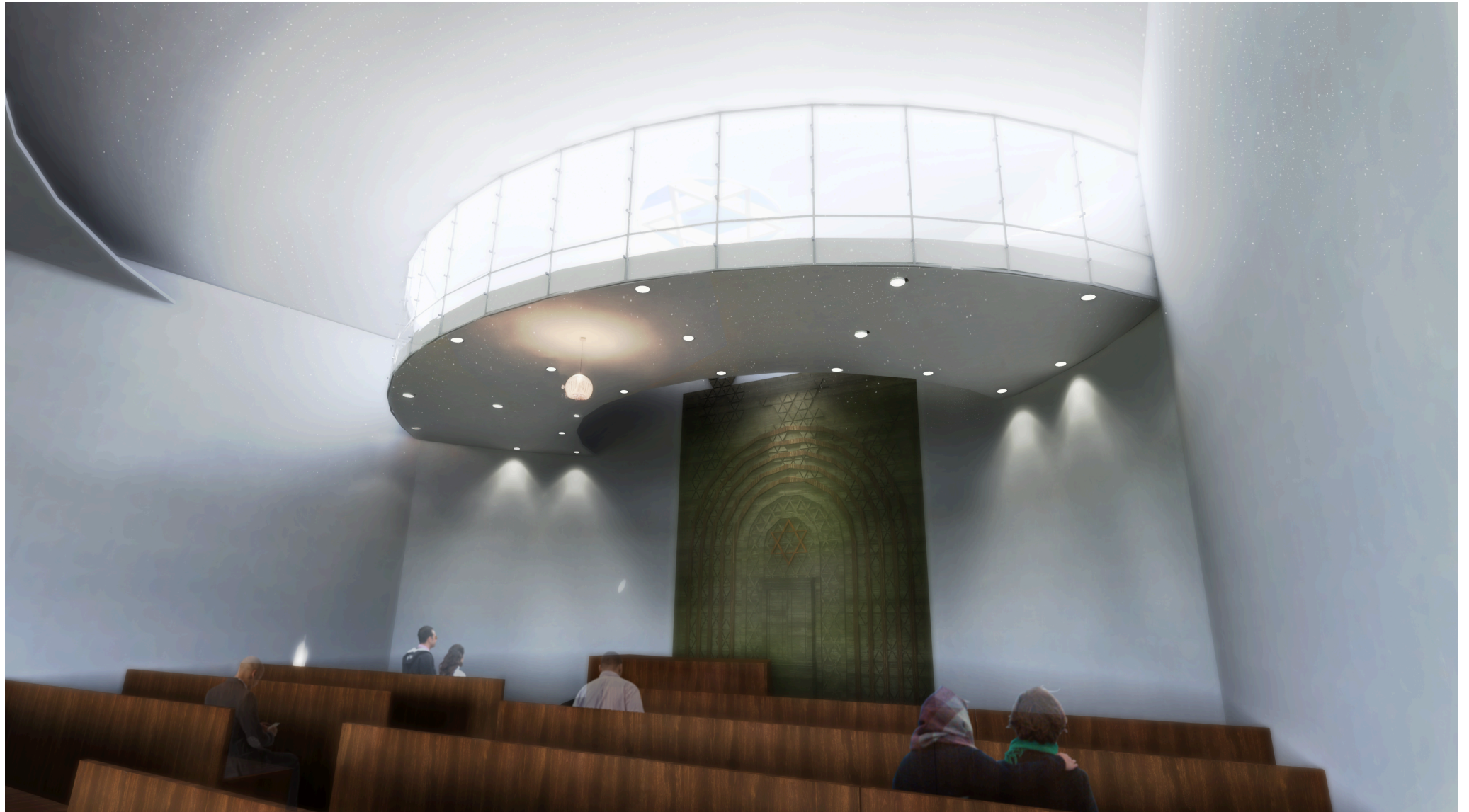

Synagogue

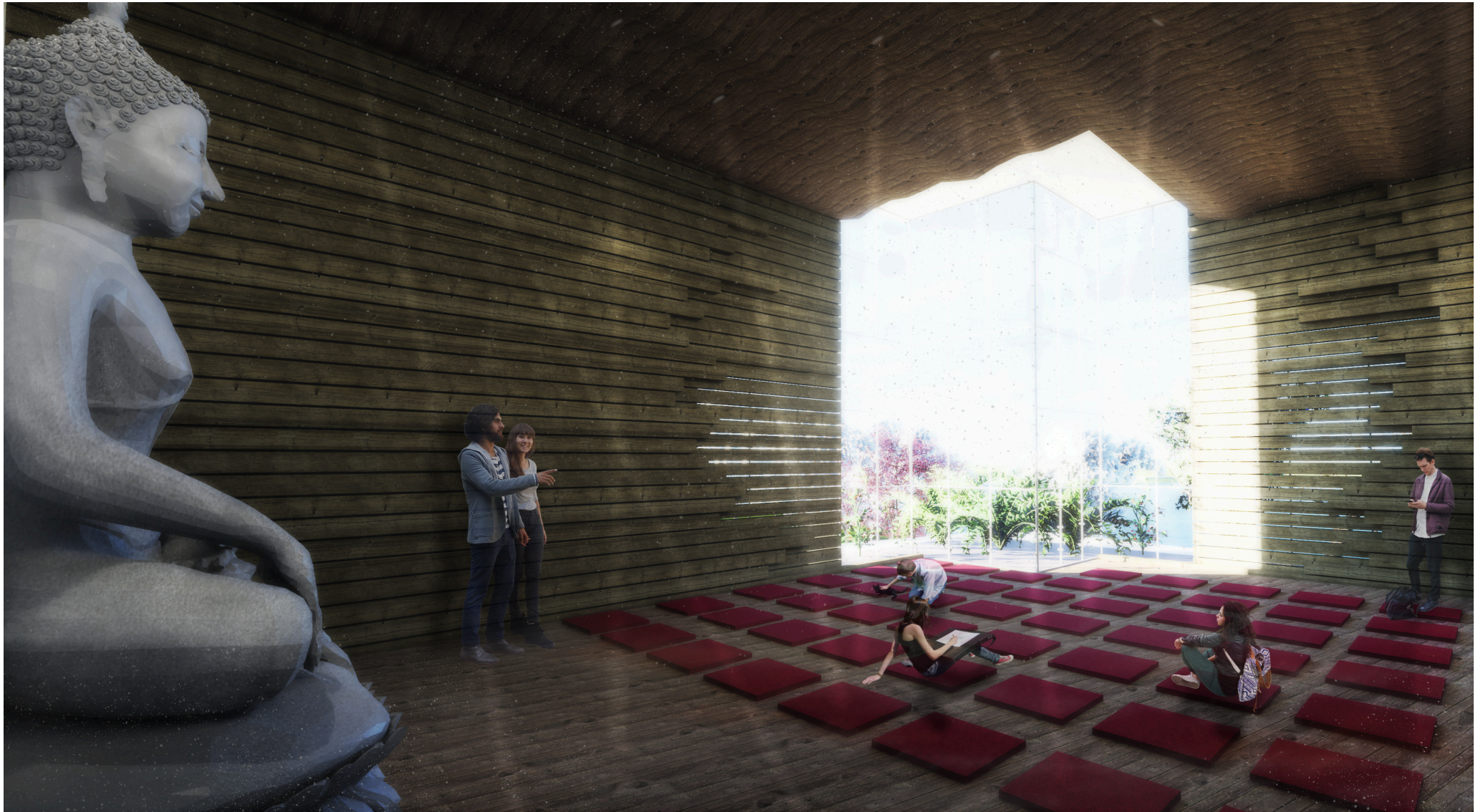

Zen Buddhist Temple



Labyrinth Walk

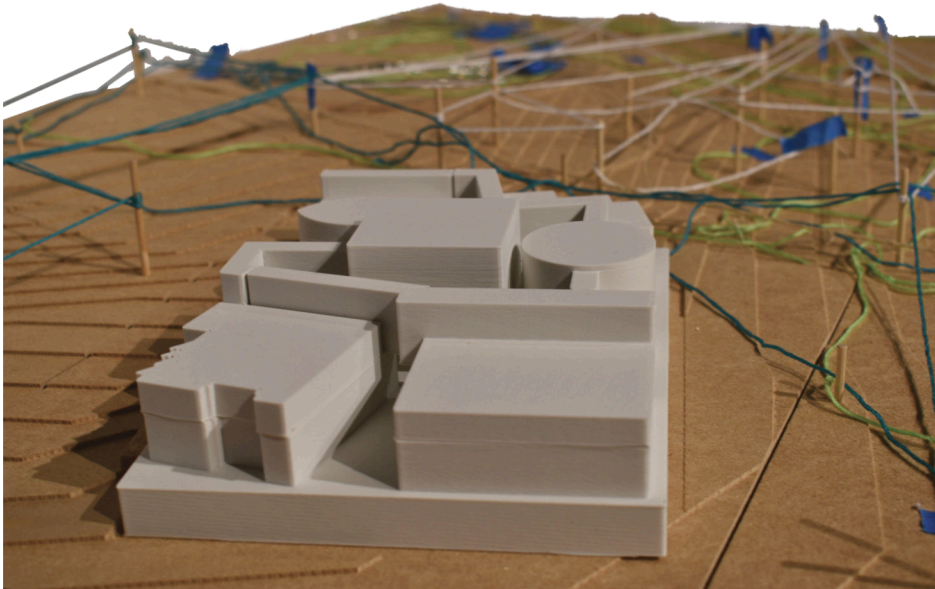
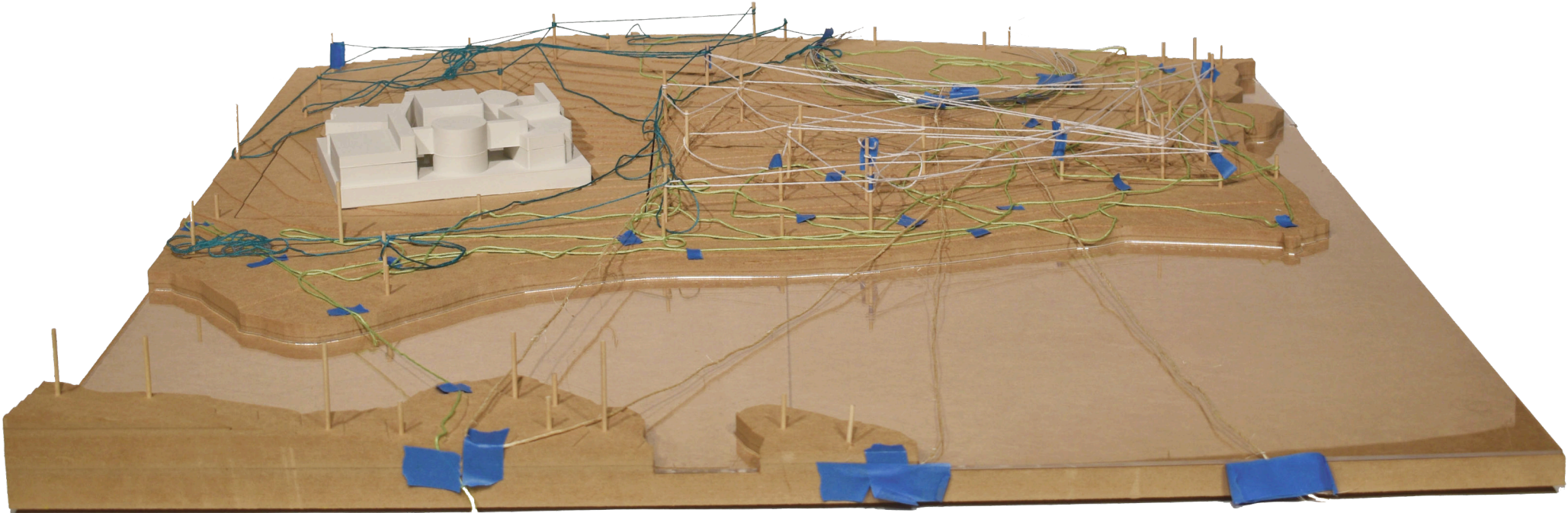

Penn State University | The Stuckeman School
Department of Architecture



CAPSTONE DESIGN PROJECT BOOK
Architectural Design-Inquiry | March Studio